

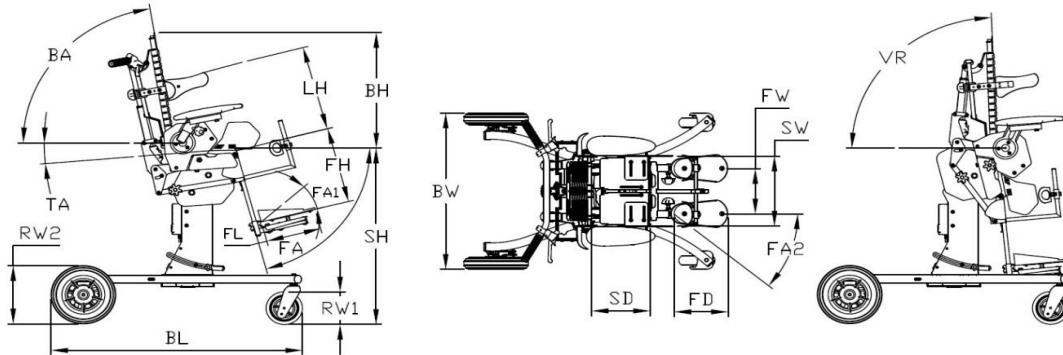

Baffin Automatic RS

## TECHNICAL DATA



		S (cm)	M (cm)	L (cm)
1	Seat height (SH)	77	77	77
2	Back height (BH)	44	52	60
3	Back angle (BA)	$0^0 \div 90^0$	$0^0 \div 90^0$	$0^0 \div 90^0$
4	Verticalization range (VR)	$0^0 \div 86^0$	$0^0 \div 86^0$	$0^0 \div 86^0$
5	Base length (BL)	88	88	88
6	Base width (BW)	72	72	72
7	Foot platform height (FH)	16÷33	16÷33	30÷48
8	Foot platform length (FL)	17	21	23
9	Wheel diameter (RW1)/(RW2)	14/25	14/25	14/25
10	Seat depth (SD)	18÷28	21÷31	29÷39
11	Seat width (SW)	18÷29	22÷33	22÷33
12	Footrest angle (FA)	$0^0 \div 90^0$	$0^0 \div 90^0$	$0^0 \div 90^0$
13	Footplate angle (FA1)	$-/+5^0$	$-/+5^0$	$-/+5^0$
14	Footplate angle (FA2)	$-/+45^0$	$-/+45^0$	$-/+45^0$
15	Footplate depth range (FD)	6	6	6
16	Footplate width range (FW)	10÷30	12÷35	12÷35
17	Tilt angle (TA)	$13^0$	$13^0$	$13^0$
18	Side support height (LH)	21÷38	21÷38	21÷40
19	Maximum user's weight	40kg	60kg	60kg
20	Weight of the device	40,8kg	44,7kg	46,2kg