

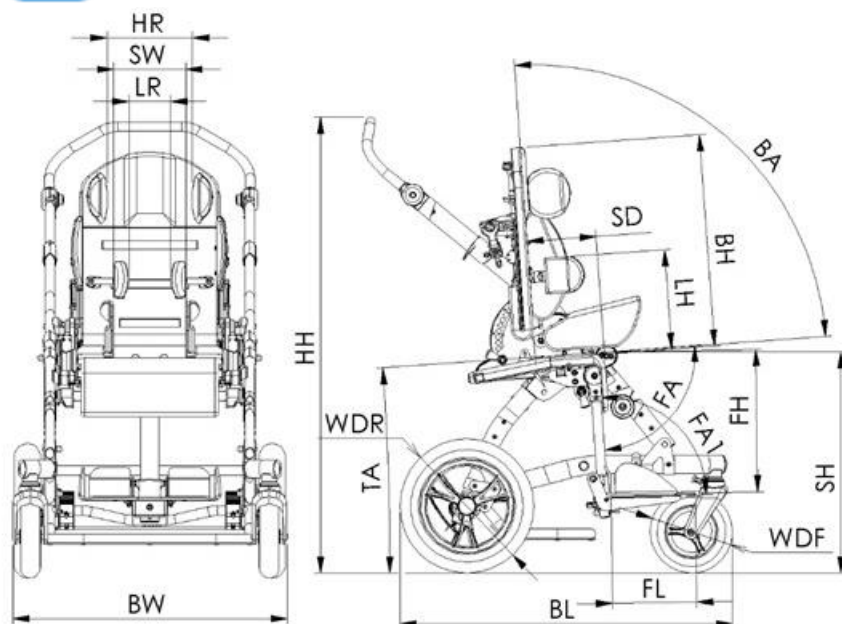

Balto

Technical Data



	Name	Description	Size		
			1	2	3
1	Seat height	SH	50	50	50
2	Backrest length	BH	50 ÷ 63	59 ÷ 75	61 ÷ 82
3	Lateral support height	LH	12 ÷ 39	12 ÷ 39	15 ÷ 47
4	Lateral support span	LR	12 ÷ 25	12 ÷ 25	18 ÷ 31
5	Head support span	HR	17 ÷ 24	17 ÷ 24	19 ÷ 26
6	Backrest angle	BA	90° ÷ 160°	90° ÷ 160°	90° ÷ 160°
7	Seat depth	SD	15 ÷ 30	22 ÷ 37	30 ÷ 45
8	Hip support span (seat width)	SW	17 ÷ 30	17 ÷ 30	22 ÷ 38
9	Footrest height	FH	16 ÷ 31	16 ÷ 38	16 ÷ 42
10	Footrest length	FL	19	19	19
11	Footrest adjustment angle	FA	0° ÷ 90°	0° ÷ 90°	0° ÷ 90°
12	Foot Platform adjustment angle	FA1	81° ÷ 90°	81° ÷ 90°	81° ÷ 90°
13	Back tilt	TA	4° ÷ 49°	4° ÷ 49°	4° ÷ 49°
14	Base length	BL	78	78	78
15	Base width	BW	63,5	63,5	69,5
16	Front wheel diameter	WDF	19	19	19
17	Rear wheel diameter	WDR	29	29	29
18	Push handle height	HH	77 ÷ 107	77 ÷ 107	81 ÷ 118
19	Maximum patient's weight		60	60	60
20	Maximum loading of the buggy (patient's weight + extra loading)		60	60	60
21	Trolley weight		21	22,5	25